

2.5 TDI INJECTION PUMP DRIVE FROM VOLKSWAGEN AG – ASSEMBLY INSTRUCTIONS FOR TENSIONER PULLEY 55741

TECHNICAL INFO NO. 1051

VEHICLE MANUFACTURER / MODELS:

Audi	A4, A6, A8
Skoda	Superb
VW	Passat

APPLIES TO ENGINES:

2.5 TDI

APPLIES TO PART NO.:

RUVILLE-No.	OE-No.:
55741	059 109 243 L (new)
	059 109 243 F (replaced)
	059 109 243 G (replaced)

55741 CONTAINED IN:

TIMING BELT SET	ROLLER SET
5574170	5570356
5570376	5570357
5570377	

IMPORTANT NOTES!

Tool information: Use a special tool to assemble the tensioner pulley (22mm cutaway hexagonal socket e.g. Klann KL-0369-10)

Tensioner 55741 is assembled behind the mounting bracket. The Hexagon fitting on the back face is not intended for assembly or adjustment.

Note the specifications of the vehicle manufacturer!

Notes on assembling the tensioner pulley:

- 1) Mount tensioner pulley 55741 to the attachment point
- 2) Position the timing belt (note running direction!)
- 3) Attach cutaway hexagonal 22mm socket (see tool information) and an allen key (see image 1 point 2)
- 4) Turn the allen key anti-clockwise until the markings are one above the other (see detailed view 1 in Image 1)
- 5) Hold the allen key in this position and tighten the attachment nut using the cutaway hexagonal socket (tightening torque: 37 Nm \pm 3 Nm)
- 6) Once all work on the timing belt drive is complete, manually turn the crankshaft through at least 2 revolutions and check the TDC markings again. Retensioning may be necessary.

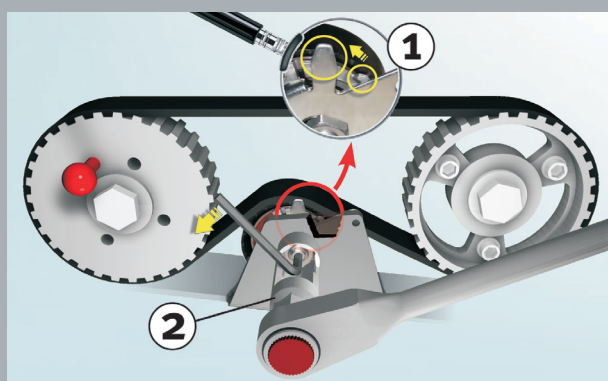

Image 1: Drive and item overview, tensioner pulley and special tool

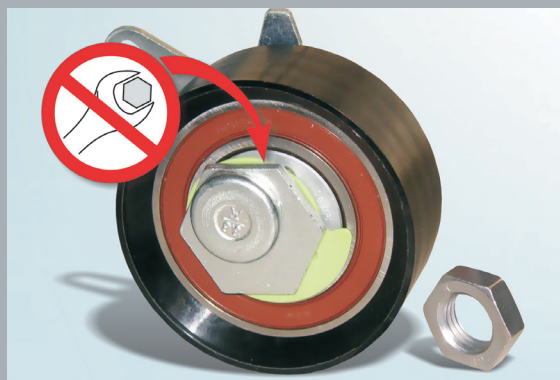

Image 2: The hexagon fitting on the back of the tensioner pulley has no function



INFORMATION

Corresponding spare parts can be found in our online catalogue at www.ruville.de. Where reference is made to the spare parts numbers of the vehicle manufacturers, this is only for the purposes of comparison.